



**LAND MAP
OF
PETERBOROUGH**

REPRODUCED BY G. S. MORISON FROM MAP IN THE
HANDWRITING OF
HON. JEREMIAH SMITH L.L.D.
TRANSCRIBED IN 1787.

NORTH LINE, RUNNING EAST, 6 MILES.

WIFFORD'S LIT. BOSTON.

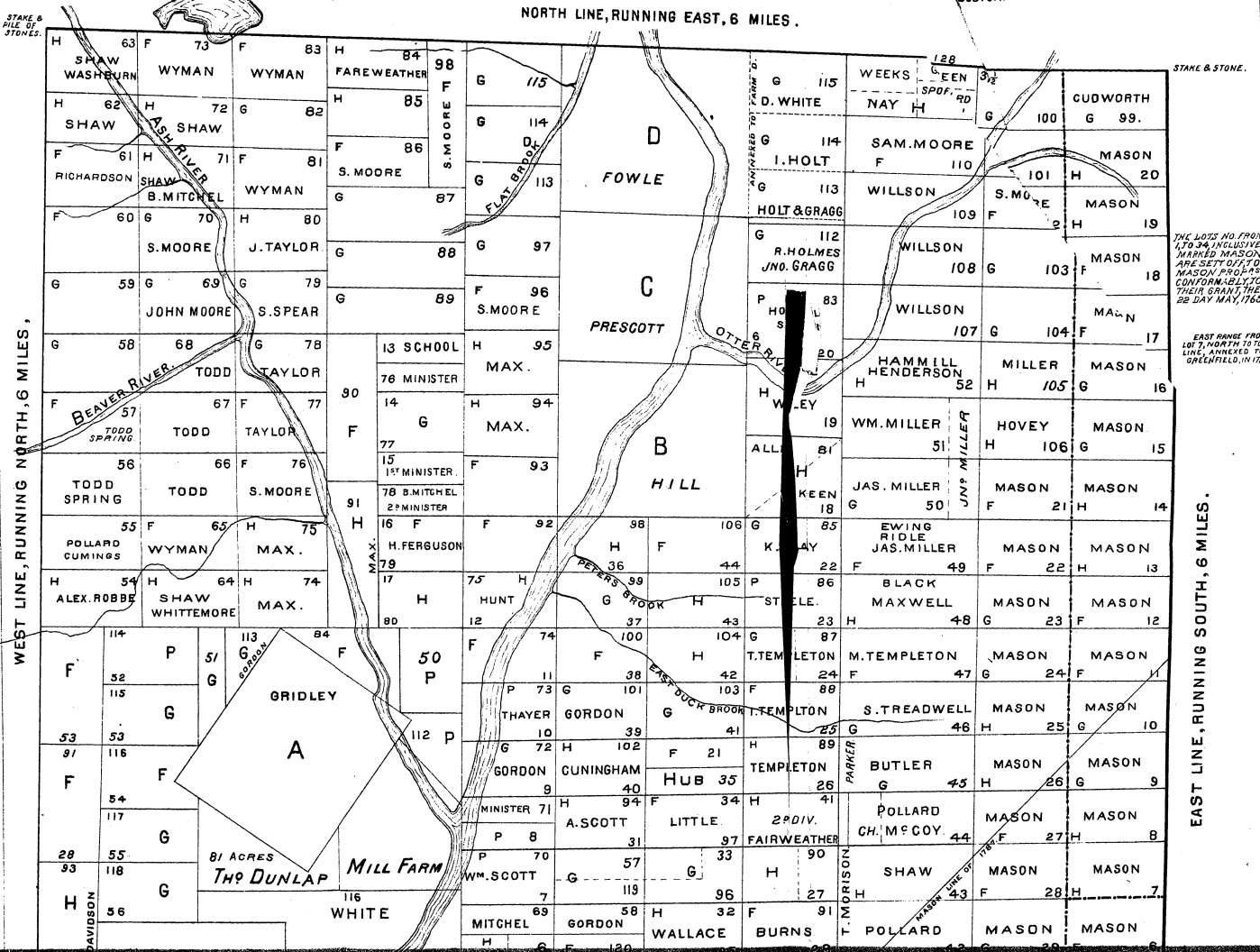

THE LOTS NO. FROM 1 TO 34 INCLUSIVE, MARKED MASON, ARE SET OFF TO MASON PROPER CONFORMABLY TO THEIR GRANT, THE 22 DAY MAY, 1765.

EAST RANGE FROM 107 1/2 NORTH TO TOWN LINE, ANNEXED TO GREENFIELD, IN 1791.

WEST LINE, RUNNING NORTH, 6 MILES.

EAST LINE, RUNNING SOUTH, 6 MILES.

STAKE & STONES.

STAKE & STONE.

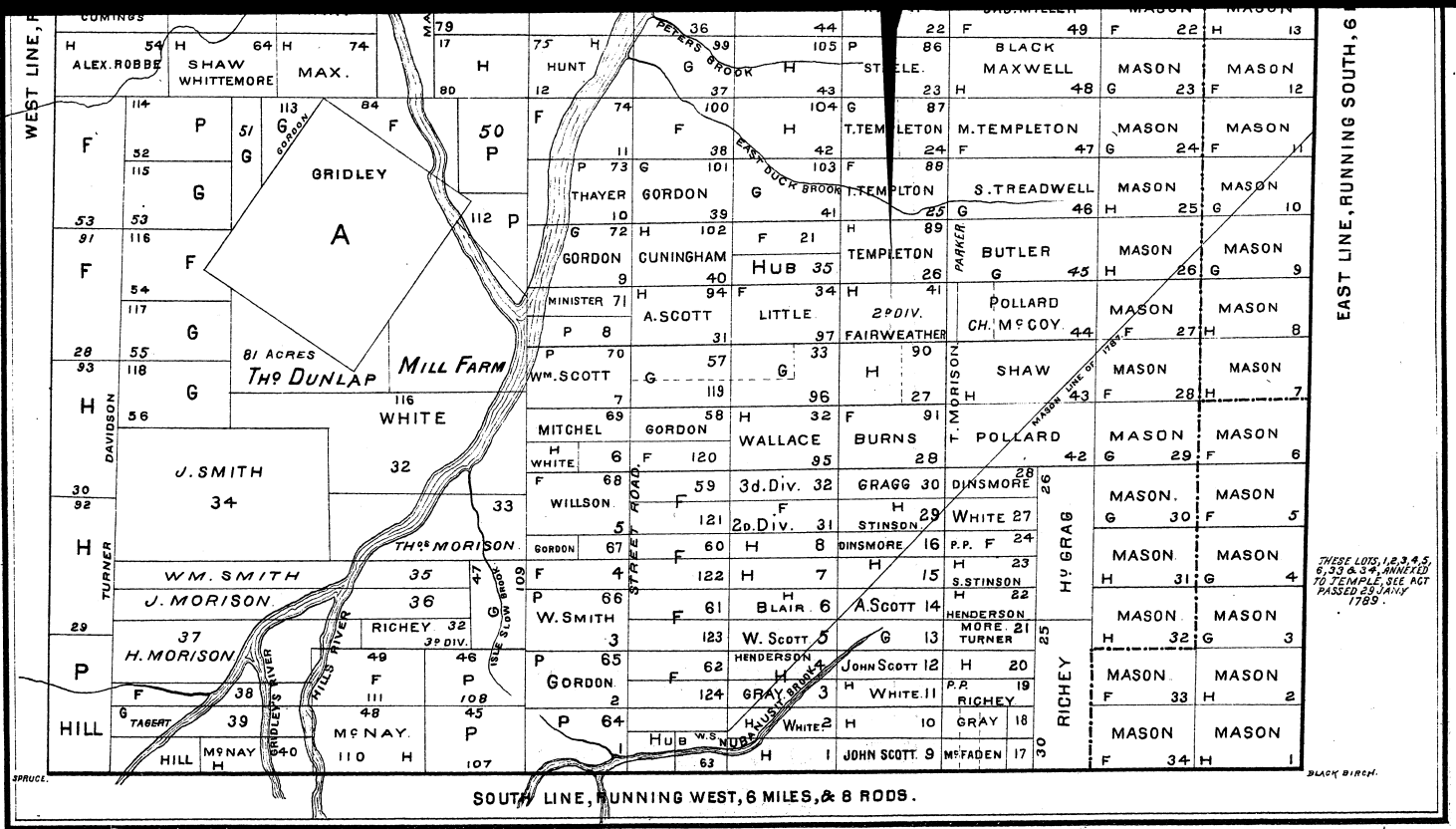

THESE LOTS 1, 2, 3 & 5,
6, 53 & 34, ANNEXED
TO TEMPLE, SEE ACT
PASSED 23 JANVY
1789.

SOUTH LINE, RUNNING WEST, 6 MILES, & 8 RODS.

BLACK BIRCH.